

Run Times and Modes

STICK DRIVE SC REAR

	DAY FLASH	FLASH 1	FLASH 2	FLASH 3	BLAST	ENDURO	FEMTO
	30 LUMENS	4 LUMENS	12 LUMENS	12 LUMENS	30 LUMENS	12 LUMENS	4 LUMENS
	5:30 h:min	16:40 h:min	6:30 h:min	23:00 h:min	1:30 h:min	3:30 h:min	9:30 h:min

Battery

Charging

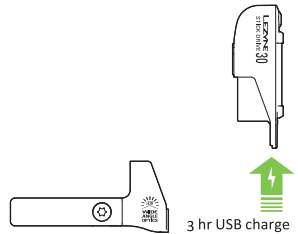
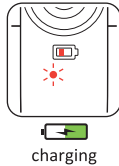
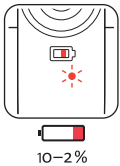

Mounting

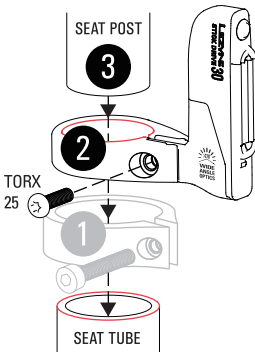

1. Unscrew and remove bike seat post clamp.
2. Replace seat post clamp with rear light mount, mount's inner upper edge sit on seat tube upper edge.
3. Insert seat post and tight screw to secure, use a torque wrench with a TORX25 and tighten to 4-7 N·m (40-71 kgf·cm).

- Before using your Lezyne LED Light for the first time, fully charge battery.
- Antes de utilizar la luz LED por primera vez, cargue completamente la batería.
- Avant d'utiliser votre lampe LED Lezyne pour la première fois, chargez complètement la batterie.
- Bevor Sie die ihre Lezyne Lampe zum ersten Mal benutzen, sollte Sie diese vollständig laden.
- 最初にLezyne LEDライトを使用する前に、バッテリーをフルに充電してください。

Lezyne USA | 645 Tank Farm Rd., Unit F, San Luis Obispo, California 93401
 LEZYNE Europe GmbH | Rolandstrasse 4, 14129 Berlin, Germany
 UK Importer: Upgrade Bikes Ltd | Partridge Green, RH13 8RA



For more info go to: www.lezyne.com/support.php